



Trilogy® Lake Norman - Plan 5545 - Balsam

2-3 Bedrooms - 2.5-3 Bathrooms - 2-3 Car Garage - 2505 Sq. Ft.
6844 Shoal Creek Dr., Denver, NC 28037
(704) 385-4063

Elevation New Farmhouse - Color Package 26C



Prices subject to change without notice. Please see your Community Representative with any questions. Sales: Shea Communities Marketing Company (NV #B.144675); Construction: SHALC GC, INC. (NV #NSCB0080574). Homes at Trilogy® are intended for occupancy by at least one person 55 years of age or older, with certain exceptions for younger persons as provided by law and the governing covenants, conditions and restrictions. This is not an offer of real estate for sale, or a solicitation of an offer to buy, to residents of any state or province in which registration and other legal requirements have not been fulfilled. Trademarks are property of their respective owners. Equal Housing Opportunity.

Floor 1

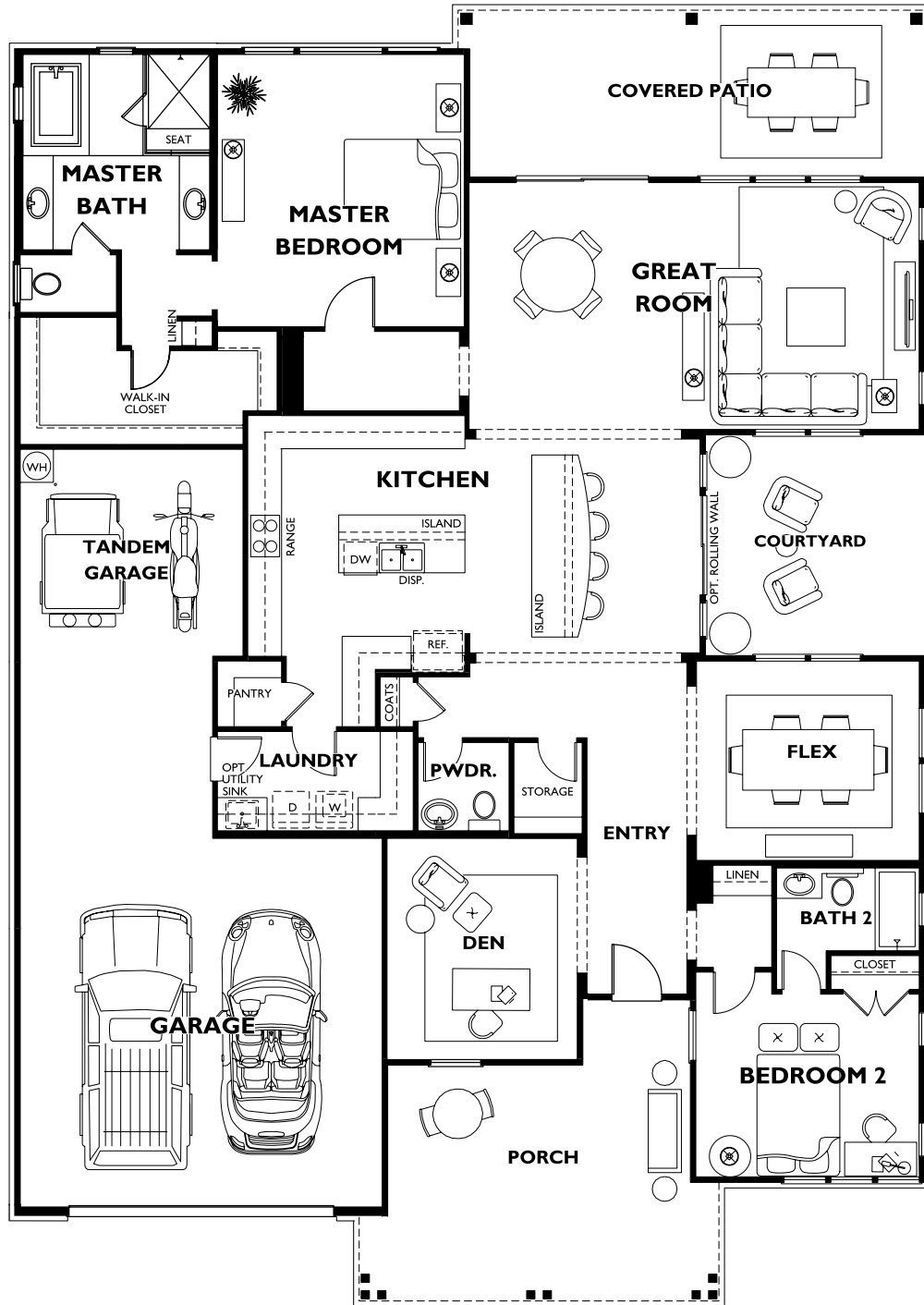

The following options are available but not selected : 4' Garage Extension, 3rd Car Garage, Extended Covered Patio, Sunroom & Covered Patio, Outdoor Fireplace at Covered Patio, Bedroom 3 & Bath 3, Double Doors at Den, Fireplace at Great Room, Rolling Wall at Great Room, Rolling Wall at Great Room, Smart Space w/ Hideway, Bay Window at Master Bedroom, Wine Room, Hideway